

## Drip Flow System

Custom Covers has developed a new aluminium insert for both our standard profiles. These inserts replace the existing steel inserts saving weight and giving a more accurate fit to any joints.

Coverspan frames have always had the flexibility to allow wider spans and taller legs by using aluminium extensions with steel inserts. This flexibility has now been enhanced by replacing the steel insert with a shaped aluminium insert.

The larger aluminium insert will be used to provide the keystone inserts for 12m to 15m roof beams and leg extenders for the 114 x 80 leg profiles. The smaller insert is used for the leg extensions and the bottom of the gable legs. It is also used for the insert connecting the 3m curved roof beam allowing 6, 9 & 12m span structures.

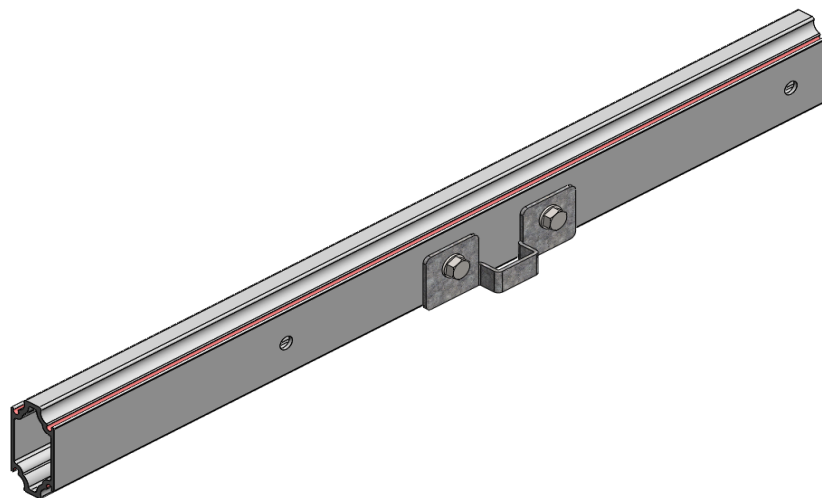

Drip flow system highlighted

## Key Features

- Lightweight insert to connect roof beam or legs
- New design with improved water flow across the joint
- Tight tolerance to reduce flex over roof joint
- Fully compatible with existing CC extrusions

## New System vs. Old System

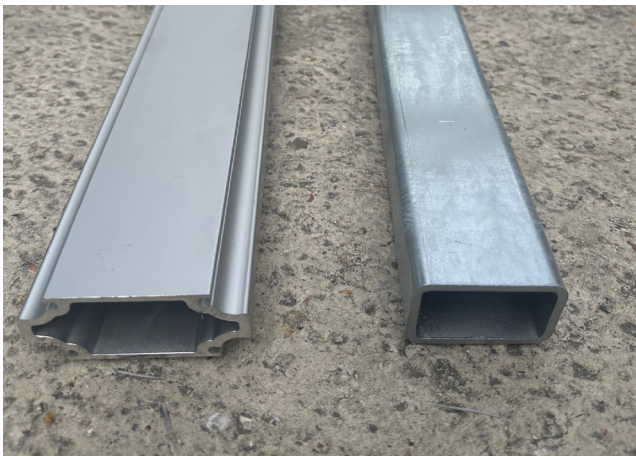

### New Drip Flow System

- Each large aluminium insert weighs 3kg.
- New design reduces movement with a flush finish and tighter tolerances.
- Drip flow system allows water to flow down the inside of the beam to the corners of the frame reducing tent leaking.

vs.

### The Old System

- Each large steel insert weighs 8kg making it harder to lift.
- Straight insert leaving gap for movement
- Higher risk of leak into the tent at the joints.

**INNOVATIVE DESIGN**  
custom made with customers in mind



**MUTA** | ACCREDITED  
SUPPLIER  
MEMBER

**Custom Covers (1984) Ltd**

Quayside Road, Bitterne Manor  
Southampton SO18 1AD

Tel: +44 (0)23 8033 5744 sales@customcovers.co.uk  
Fax: +44 (0)23 8022 5581 www.customcovers.co.uk